

ITEM NO.	PART NUMBER	DESCRIPTION	QTY.
1	Chassis Top-2		1
2	BRKT Caster Wheel		1
3	RT-Assy Motor Mount and Wheel		1
4	LT-Assy Motor Mount and Wheel		1
5	Assy Caster Wheel		1
6	91780A090	STANDOFF, 3/8 HEX X 4.0 LONG X 10-32 THDS	4
7	PEM NUT, CLA-032-1	PEM NUT ALUM 10-32	2
8	91255A263	BUTTON HD SCR, 10-32 X 3/8 LONG	10
9	91251A537	SHCS, 1/4-20 X 1/2 LONG	4
10	92510A067	SPACER, 1/4 DIA X .81 LONG, NO. 6 SCREW	3
11	CLA-440-1	PEM NUT ALUM 4-40	3
12	91864A061	SHCS, 1/4-20 X 5/16 LONG	4
13	92510A763	SPACER, 1/2 DIA X 5/16 LONG, NO.1/4 SCREW	4
14	90044A112	SHCS, 6-32 UNC X 1.25 LONG	3
15	Turntable MX-28 PRO SERIES		1
16	91306A311	BUTTON HD SCR, 4-40 X 1/4 LONG	3
17	Bottom Plate		1

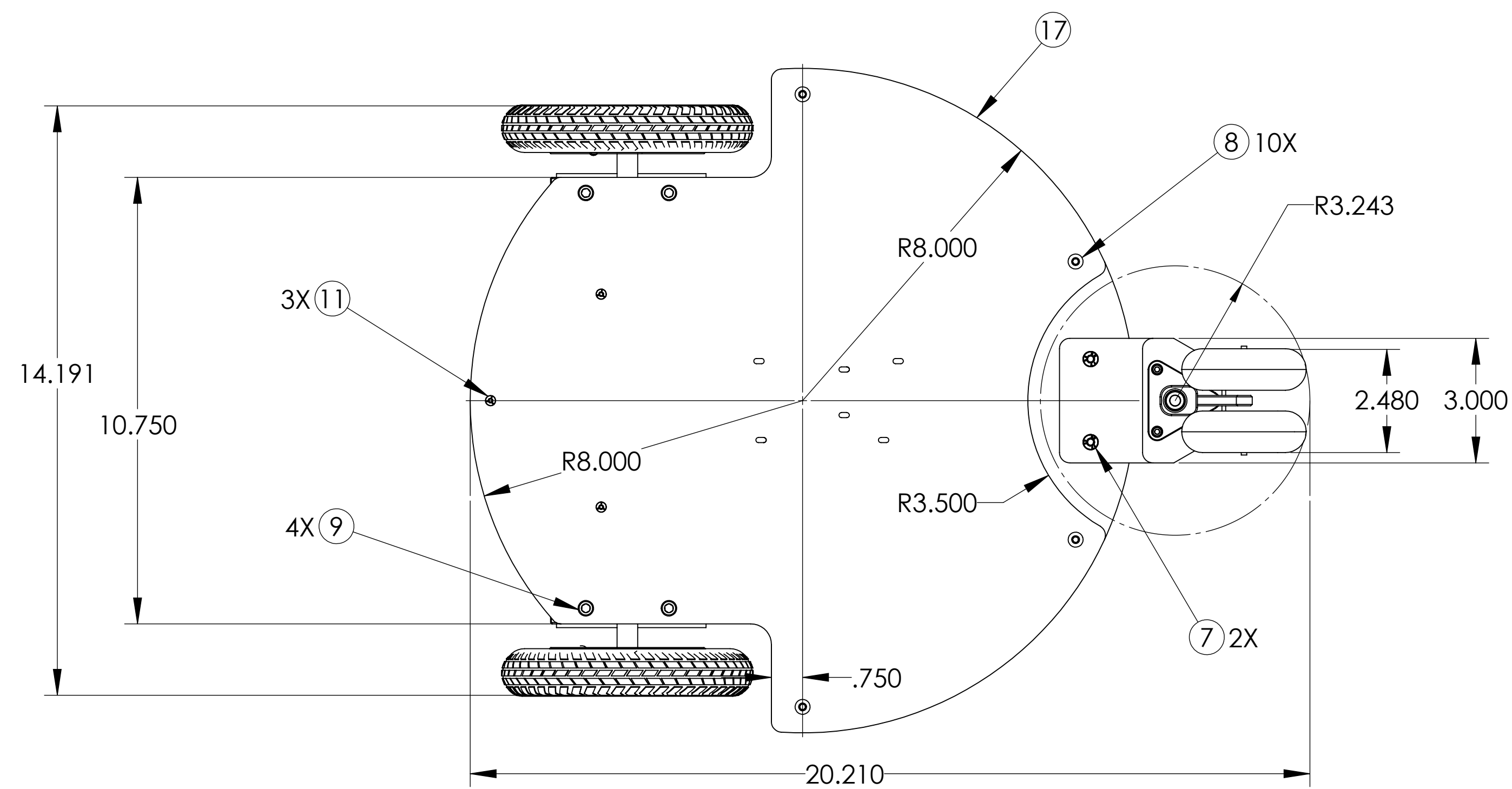
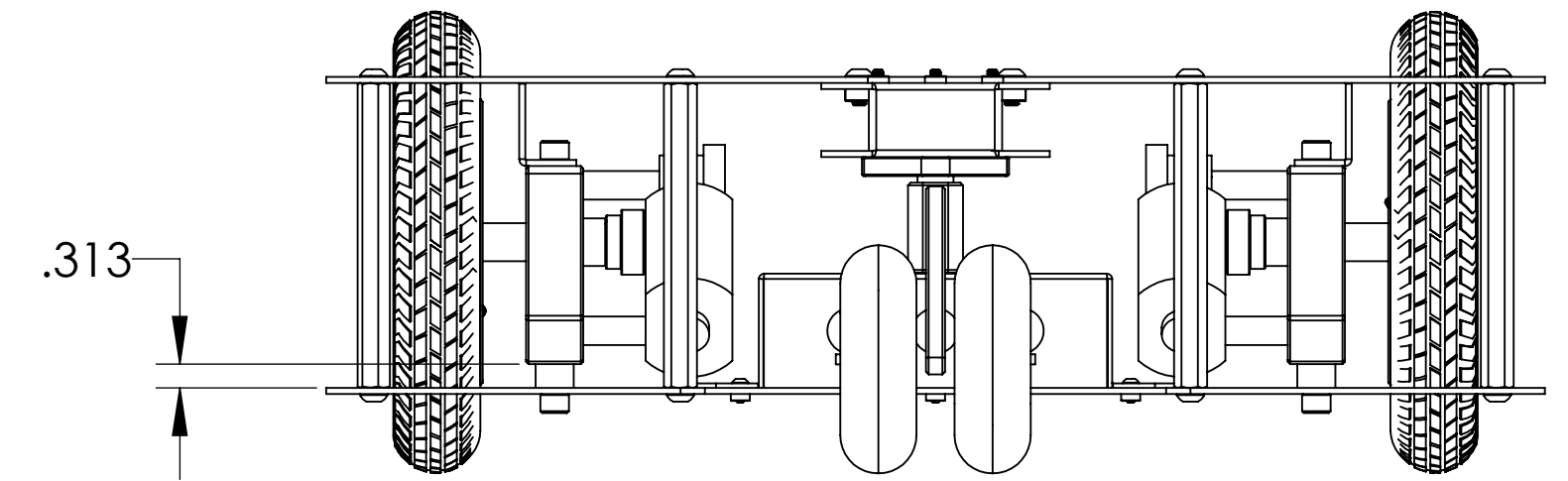
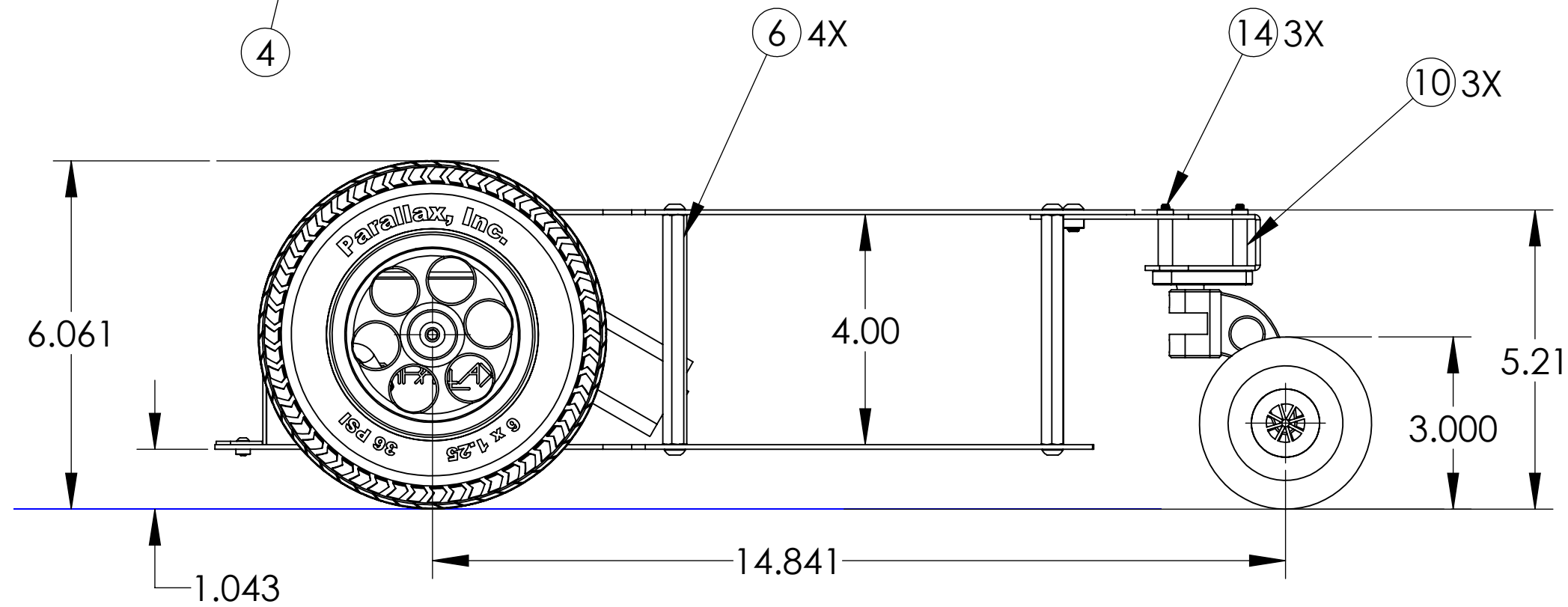
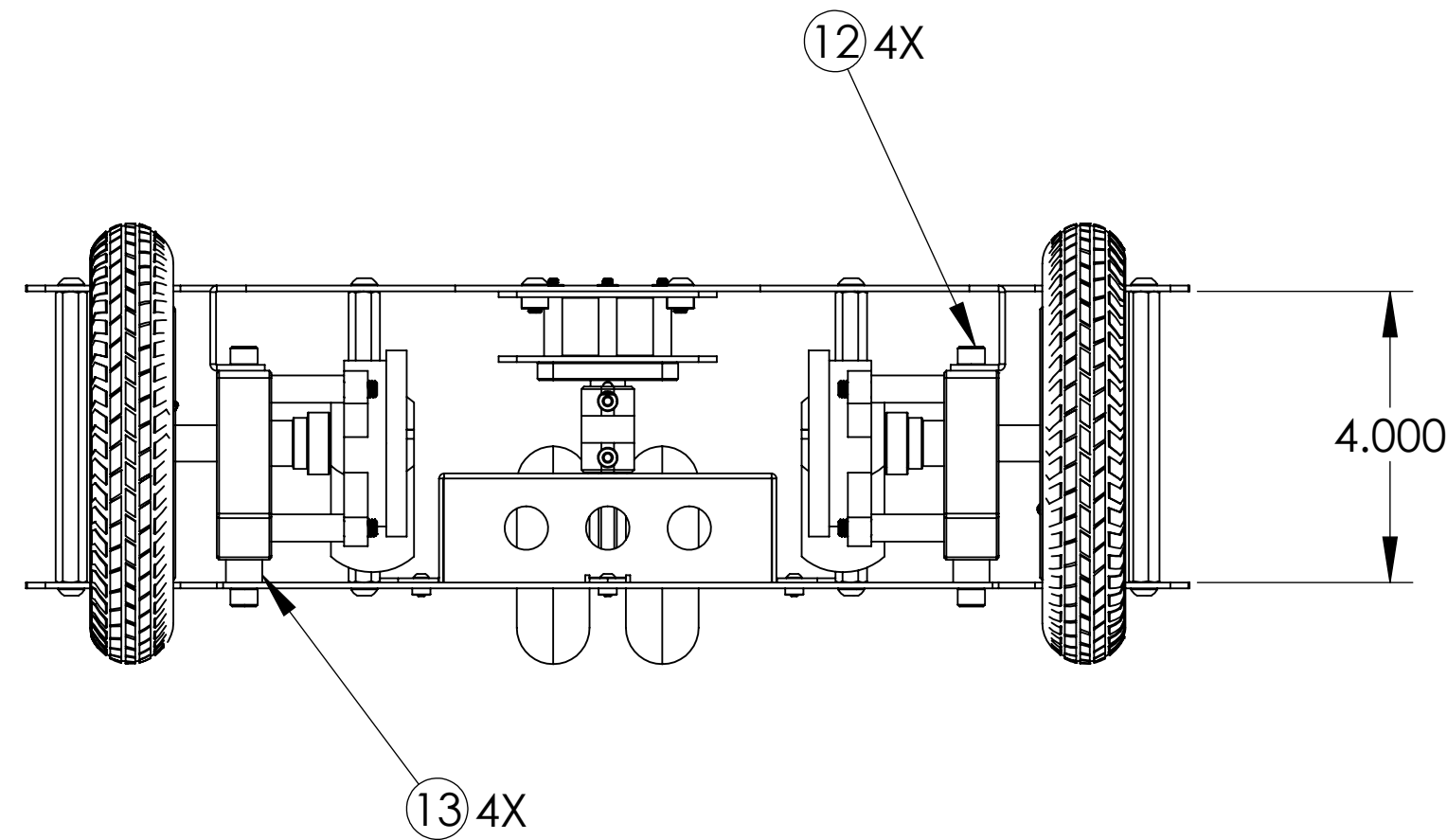
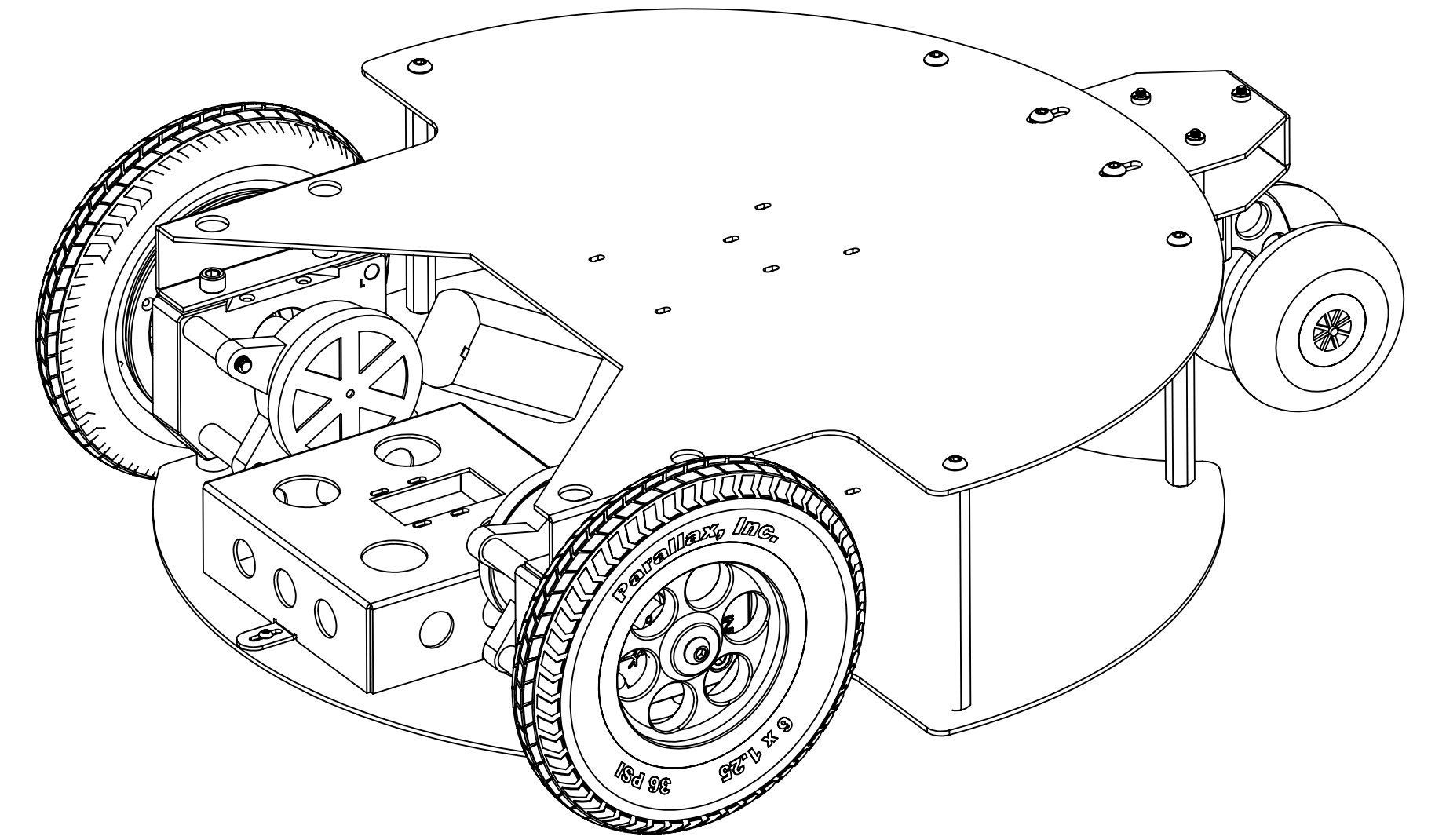
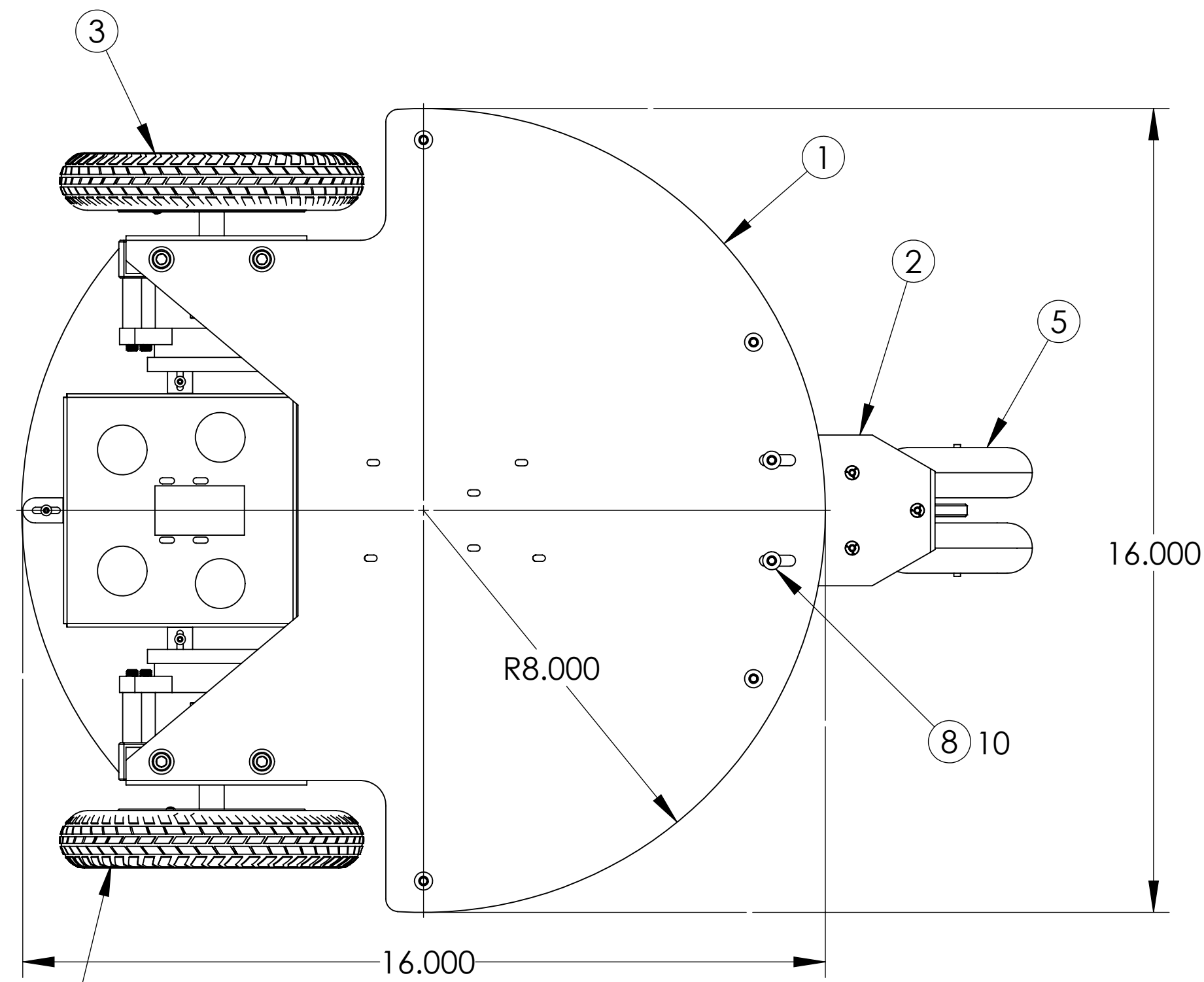

PROPRIETARY AND CONFIDENTIAL
 THE INFORMATION CONTAINED IN THIS
 DRAWING IS THE SOLE PROPERTY OF
 WHITE UMBRELLA ENTERPRISES LLC. ANY
 REPRODUCTION IN PART OR AS A WHOLE
 WITHOUT THE WRITTEN PERMISSION OF
 WHITE UMBRELLA ENTERPRISES LLC IS
 PROHIBITED.

UNLESS OTHERWISE SPECIFIED:		NAME	DATE	WHITE UMBRELLA ENTERPRISES LLC
DIMENSIONS ARE IN INCHES	DRAWN	AL GARCIA	3-16-18	TITLE:
FRACTIONAL ±	CHECKED			ROVER ASSEMBLY
TOLERANCES:	ENG APPR.			SIZE DWG. NO.
ANGULAR: MAACH ± BEND ±1°	MFG APPR.			D
TWO PLACE DECIMAL ±.01	Q.A.			SCALE: 1:4 WEIGHT:
THREE PLACE DECIMAL ±.005	COMMENTS:			SHEET 1 OF 1
INTERPRET GEOMETRIC TOLERANCING PER:				
MATERIAL				
FINISH				
APPLICATION	DO NOT SCALE DRAWING			